



Greendale Park

BEDLINGTON, NORTHUMBERLAND

A beautiful collection of two, three and four bedroom homes
in the historical town of Bedlington in Northumberland.

Taylor
Wimpey

Contents

→ **Welcome to Greendale Park**



→ **Personalise your home**

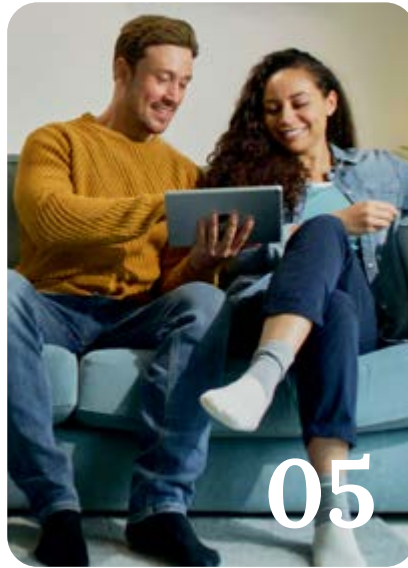

→ **Included as standard**



→ **Our homes**



→ **Ways to buy**



→ **Take your next step**



Welcome to Greendale Park

Surrounded by tranquil countryside, Greendale Park is a new collection of homes to the North of Bedlington. All of our homes come with a range of energy efficient features in a range of layouts, offering something for everyone.



[→ View the site plan](#)



The perfect location

Set just within the historic town centre of Bedlington, Greendale Park boasts a peaceful location for those looking to be part of a local community whilst enjoying what nature and the great outdoors has to offer right on their doorstep.

Local amenities such as shops, bars and restaurants can all be found just under a mile away from Greendale Park. The development provides plenty of green, open space and is ideally situated to access the stunning Northumberland coastline, plus, with a selection of primary and secondary schools nearby, it is perfect for growing families. For those looking to travel further afield, the A189 is within easy reach of the development, as well as straightforward access to the A19 and A1, linking you to the wider North East area.

Green open space

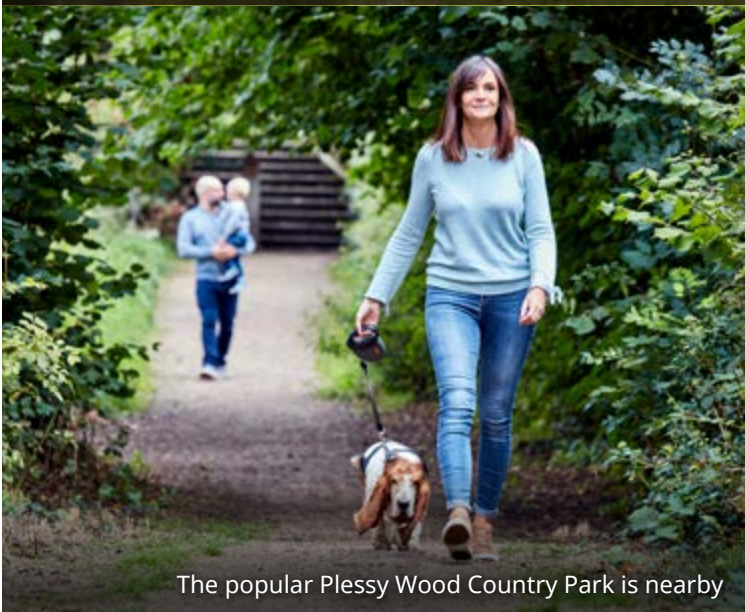

The popular Plessey Wood Country Park is nearby



Nearby Northumberland coastline



Personalise your home

A new Taylor Wimpey home is a blank canvas, ready for you to put your stamp on even before you move in. You can choose from a range of high quality options for your kitchen, bedroom and bathroom to suit your taste – and all from the comfort of your sofa. We offer dark and light kitchen units and patterned or plain tiles for your bathroom, so whatever your preferred style we've got you covered.

Using our innovative Options Online tool, you can visualise your new home room-by-room and customise each as you go. You can also choose your options with the help of your Sales Executive if you'd prefer.

Our customers have created some fantastic spaces in their homes and you can get inspiration from their choices by following us on Instagram. You can also check out a host of interior design tips on our website.

[→ Find out more](#)



Options availability is subject to build stage of plots and options won't be available if plots have reached a certain build stage. Please contact the Sales Executive for further information.

Included as standard

From the external features to the finishing touches, every detail of our homes is designed with our customers in mind.

While you'll have the choice to upgrade some of our standard offerings, all of our houses are fitted with a range of high quality features at no extra cost to you.

You'll find a complete list of all items that come as standard in your house below.



Kitchens

All of our kitchens are fitted with beautiful units and worktops and you can choose your preferred style and colour to create your perfect cooking and entertaining space.

A range of accessories including stylish splashbacks, a stainless steel sink and Zeno Taps, and lighting give your kitchen a clean, contemporary finish. You'll get a modern, energy efficient Electrolux oven with built-in gas hob and integrated hood and extractor fan too.

Utility rooms[†]

Units will be fitted to match your chosen kitchen style, complete with a stainless steel sink and Zeno Taps. If your home has a toilet in the utility room, we'll fit a contemporary white basin and toilet for a sleek finish.



Bathrooms, en suites and shower rooms

Modern white sanitaryware, including toilet, basin and bath with chrome Ideal Standard taps give your main bathroom a clean look. The same sanitaryware is fitted in en suites and shower rooms which also benefit from an Aqualisa shower and glass enclosure. For a distinct look, we offer a varied range of Porcelanosa ceramic wall tiles for you to choose from to make your bathroom and en suite stand out from the crowd.



Garden[†]

The outside of your home is just as carefully considered as the inside. You'll get a fully turfed and landscaped front garden – including plants. The back garden includes a slabbed area and your privacy is protected by a garden fence.



All of the specification listed is included in our houses as standard. For the specification included in our apartments, please see the separate apartment specification list. Standard specifications are correct at time of going to print, but are subject to change without notice. Please contact the Sales Executive for further information. † = Where applicable.

Specification of our houses

Kitchen & Utility	
A contemporary fitted symphony kitchen including stainless steel splashback above hob	✓
Utility room designed to mirror kitchen (house type dependent)	✓
Choice of worktops with matching upstands	✓
1.5 bowl stainless steel inset sink with tap (house type dependent)	✓
Stainless steel integrated 4 burner gas hob	✓
Integrated cooker hood	✓
Stainless steel integrated Electrolux oven	✓
1 electric double socket to incorporate USB charge point with standard sockets and switches as indicated on working drawings - white	✓
Bathrooms, en suites and cloakrooms	
Extractor fan	✓
Splashback tiling to basin in wet rooms and cloakroom	✓
Porcelanosa full height tiling within shower enclosure to en suite	✓
Free standing sanitary ware - white	✓
Chrome basin tap single mixer and pair of chrome bath taps	✓
White shower tray to en suite	✓
Chrome with clear glass shower door to en suite	✓
Thermostatic chrome shower	✓
Central heating/hot water system	
Waste water heat recovery for showers	✓
Fully programmable gas central heating providing hot water	✓
White thermostatic controlled radiators	✓
Cavity wall insulation	✓
Loft insulation in line with building regulations	✓
Electrical features	
Standard sockets and switches as indicated on working drawings - white	✓
Electric Car Charging 7kW wall/post mounted point [†]	✓
TV socket to lounge and bedroom one (as indicated on drawings)	✓
One double socket in kitchen to incorporate USB charging points	✓
Light to garages within curtilage area (site layout dictates)	✓
Batten light point to garage where in plot curtilage (where applicable)	✓

✓ = Standard features. † = Electric Car Charging point will be wall or post mounted depending on plot.

All of the specification listed is included in our houses as standard. For the specification included in our apartments, please see the separate apartment specification list. Recent changes in building regulations may affect the energy performance calculation on some new build homes. This means that the addition of a shower over a bath as an upgrade may no longer be available on selected homes. Please speak to our Sales Executive to find out more. Standard specifications are correct at time of going to print, but are subject to change without notice. Please contact the Sales Executive for further information.

Specification of our houses

Finishing touches	
White emulsion to walls and ceilings	✓
White pre-finished internal doors with chrome handles	✓
Black pre-finished GRP front entrance door with three point locking system and chrome ironmongery	✓
Electrical sockets and switches to all garages (in plot curtilage)	✓
External Features	
External front light and wiring for rear	✓
PV Solar panels	✓
Triple glazed windows	✓
PVCu French doors to rear	✓
Security and Safety	
Mains operated smoke detectors supplied	✓
Carbon monoxide detectors supplied	✓
Gardens, Paths and Drives	
Hard standing area to rear garden for wheelie bin storage	✓
Outside tap to rear elevation	✓
Grey concrete paving slabs to pathways and patios	✓
Front garden turfed or shrubbed	✓
1.8m closeboard fencing to rear garden	✓
Permeable Block Paved driveway	✓
Other Features	
NHBC 10 year build mark policy	✓
Taylor Wimpey warranty for 2 years from date of legal completion	✓

 [Find out more](#)

✓ = Standard features. † = Electric Car Charging point will be wall or post mounted depending on plot.

All of the specification listed is included in our houses as standard. For the specification included in our apartments, please see the separate apartment specification list. Recent changes in building regulations may affect the energy performance calculation on some new build homes. This means that the addition of a shower over a bath as an upgrade may no longer be available on selected homes. Please speak to our Sales Executive to find out more. Standard specifications are correct at time of going to print, but are subject to change without notice. Please contact the Sales Executive for further information.

Our homes

[→ 4 bedroom homes](#)



[→ 3 bedroom homes](#)



[→ 2 bedroom homes](#)



[→ View the site plan](#)



The Bittesford

4 BEDROOM HOME, TOTAL 1,253 sq ft / 115.0m²



GROUND FLOOR

Living room
3.48m × 4.40m 11' 5" × 14' 5"

Kitchen/Dining
5.30m × 4.39m 17' 5" × 14' 5"



FIRST FLOOR

Bedroom 1
3.51m × 3.40m 11' 6" × 11' 2"

Bedroom 2
3.16m × 2.93m 10' 4" × 9' 8"

Bedroom 3
2.45m × 3.04m 8' 0" × 10' 0"

Bedroom 4
2.13m × 3.51m 7' 0" × 11' 6"

[→ Discover more about this home](#)

[→ View our current availability](#)

*This window is plot specific, please speak to our Sales Executive for further details. The floor plans depict a typical layout of this house type. For exact plot specification, details of external and internal finishes, dimensions and floor plan differences consult your sales executive. All dimensions are + or - 50mm and floor plans are not shown to scale. The kitchen layout and furniture positions are for indicative purposes only. The computer generated image is for illustrative purposes only and it is from an imaginary viewpoint within an open space area. Its purpose is to give a feel for the development, not an accurate description of each property. The illustration shows a typical Taylor Wimpey home of this type, but there are, however, variances from site to site. External materials, finishes, landscaping and the position of garages (where provided) may vary throughout the development. Properties may also be built handed (mirror image). Images may include optional upgrades at an additional cost. Please ask for further details, TWNE 75242 / August 2024



The Chalham

4 BEDROOM HOME, TOTAL 1,286 sq ft / 118.0m²



GROUND FLOOR

Living room

4.84m × 4.67m 15' 11" × 15' 4"

Kitchen/Dining

4.84m × 4.10m 15' 11" × 13' 5"



FIRST FLOOR

Bedroom 1

3.68m × 3.25m 11' 11" × 10' 8"

Bedroom 2

4.45m × 3.32m 14' 6" × 10' 9"

Bedroom 3

3.38m × 3.29m 11' 1" × 10' 8"

Bedroom 4

2.84m × 4.84m 9' 4" × 15' 11"

[→ Discover more about this home](#)

[→ View our current availability](#)

*This window is plot specific, please speak to our Sales Executive for further details. The floor plans depict a typical layout of this house type. For exact plot specification, details of external and internal finishes, dimensions and floor plan differences consult your sales executive. All dimensions are + or - 50mm and floor plans are not shown to scale. The kitchen layout and furniture positions are for indicative purposes only. The computer generated image is for illustrative purposes only and it is from an imaginary viewpoint within an open space area. Its purpose is to give a feel for the development, not an accurate description of each property. The illustration shows a typical Taylor Wimpey home of this type, but there are, however, variances from site to site. External materials, finishes, landscaping and the position of garages (where provided) may vary throughout the development. Properties may also be built handed (mirror image). Images may include optional upgrades at an additional cost. Please ask for further details, TWNE 75242 / August 2024



The Hubham

4 BEDROOM HOME, TOTAL 1,389 sq ft / 127.0m²



GROUND FLOOR

Living room

4.13m × 3.60m 13' 7" × 11' 10"

Kitchen/Dining

3.88m × 5.81m 12' 9" × 19' 1"

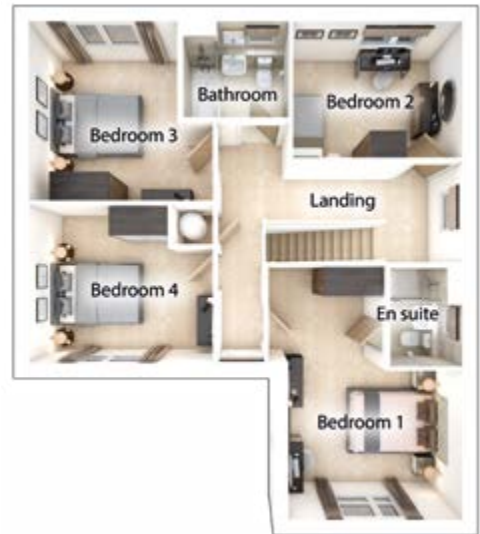

FIRST FLOOR

Bedroom 1

5.27m × 3.61m 17' 3" × 11' 10"

Bedroom 2

3.29m × 3.75m 10' 10" × 12' 4"

Bedroom 3

3.71m × 3.08m 12' 2" × 10' 1"

Bedroom 4

2.84m × 3.51m 9' 3" × 11' 6"

[→ Discover more about this home](#)

[→ View our current availability](#)

*This window is plot specific, please speak to our Sales Executive for further details. The floor plans depict a typical layout of this house type. For exact plot specification, details of external and internal finishes, dimensions and floor plan differences consult your sales executive. All dimensions are + or - 50mm and floor plans are not shown to scale. The kitchen layout and furniture positions are for indicative purposes only. The computer generated image is for illustrative purposes only and it is from an imaginary viewpoint within an open space area. Its purpose is to give a feel for the development, not an accurate description of each property. The illustration shows a typical Taylor Wimpey home of this type, but there are, however, variances from site to site. External materials, finishes, landscaping and the position of garages (where provided) may vary throughout the development. Properties may also be built handed (mirror image). Images may include optional upgrades at an additional cost. Please ask for further details, TWNE 75242 / August 2024



The Kitham

4 BEDROOM HOME, TOTAL 1,535 sq ft / 141.0m²



GROUND FLOOR

Living room

4.49m x 3.83m 14' 9" x 12' 7"

Kitchen/Dining

5.42m x 5.91m 17' 9" x 19' 5"



FIRST FLOOR

Bedroom 1 max.

5.64m x 3.85m 18' 6" x 12' 7"

Bedroom 2

4.25m x 3.62m 13' 11" x 11' 11"

Bedroom 3

3.23m x 4.27m 10' 7" x 14' 0"

Bedroom 4

3.52m x 3.19m 11' 7" x 10' 6"

[→ Discover more about this home](#)

[→ View our current availability](#)

*This window is plot specific, please speak to our Sales Executive for further details. The floor plans depict a typical layout of this house type. For exact plot specification, details of external and internal finishes, dimensions and floor plan differences consult your sales executive. All dimensions are + or - 50mm and floor plans are not shown to scale. The kitchen layout and furniture positions are for indicative purposes only. The computer generated image is for illustrative purposes only and it is from an imaginary viewpoint within an open space area. Its purpose is to give a feel for the development, not an accurate description of each property. The illustration shows a typical Taylor Wimpey home of this type, but there are, however, variances from site to site. External materials, finishes, landscaping and the position of garages (where provided) may vary throughout the development. Properties may also be built handed (mirror image). Images may include optional upgrades at an additional cost. Please ask for further details, TWNE 75242 / August 2024



The Tewksdale

4 BEDROOM HOME, TOTAL 1,268 sq ft / 116.0m²



GROUND FLOOR

Living/Study

3.25m × 6.53m 10' 8" × 21' 5"

Kitchen/Dining

3.29m × 6.53m 10' 10" × 21' 5"



FIRST FLOOR

Bedroom 1

3.54m × 3.38m 11' 8" × 11' 1"

Bedroom 2

4.32m × 3.00m 14' 2" × 9' 10"

Bedroom 3

2.19m × 3.44m 7' 2" × 11' 4"

Bedroom 4

2.16m × 3.06m 7' 1" × 10' 1"

[→ Discover more about this home](#)

[→ View our current availability](#)

*This window is plot specific, please speak to our Sales Executive for further details. The floor plans depict a typical layout of this house type. For exact plot specification, details of external and internal finishes, dimensions and floor plan differences consult your sales executive. All dimensions are + or - 50mm and floor plans are not shown to scale. The kitchen layout and furniture positions are for indicative purposes only. The computer generated image is for illustrative purposes only and it is from an imaginary viewpoint within an open space area. Its purpose is to give a feel for the development, not an accurate description of each property. The illustration shows a typical Taylor Wimpey home of this type, but there are, however, variances from site to site. External materials, finishes, landscaping and the position of garages (where provided) may vary throughout the development. Properties may also be built handed (mirror image). Images may include optional upgrades at an additional cost. Please ask for further details, TWNE 75242 / August 2024



The Brambleford

3 BEDROOM HOME, TOTAL 922 sq ft / 84.0m²



GROUND FLOOR

Living room

3.94m × 3.83m

12' 11" × 12' 7"

Kitchen/Dining

4.75m × 3.07m

15' 6" × 10' 10"



FIRST FLOOR

Bedroom 1

3.06m × 3.10m

10' 1" × 10' 4"

Bedroom 2

3.42m × 2.50m

11' 3" × 8' 3"

Bedroom 3

2.35m × 2.13m

7' 9" × 7' 0"



[Discover more about this home](#)



[View our current availability](#)

*This window is plot specific, please speak to our Sales Executive for further details. The floor plans depict a typical layout of this house type. For exact plot specification, details of external and internal finishes, dimensions and floor plan differences consult your sales executive. All dimensions are + or - 50mm and floor plans are not shown to scale. The kitchen layout and furniture positions are for indicative purposes only. The computer generated image is for illustrative purposes only and it is from an imaginary viewpoint within an open space area. Its purpose is to give a feel for the development, not an accurate description of each property. The illustration shows a typical Taylor Wimpey home of this type, but there are, however, variances from site to site. External materials, finishes, landscaping and the position of garages (where provided) may vary throughout the development. Properties may also be built handed (mirror image). Images may include optional upgrades at an additional cost. Please ask for further details, TWNE 75242 / August 2024



The Tetford

3 BEDROOM HOME, TOTAL 1,036 sq ft / 95.0m²



GROUND FLOOR

Living room

3.85m × 3.30m 12' 8" × 10' 10"

Kitchen/Dining

4.90m × 3.07m 16' 10" × 10' 10"



FIRST FLOOR

Bedroom 1

3.18m × 2.79m 10' 5" × 9' 2"

Bedroom 2

3.33m × 3.12m 10' 10" × 10' 3"

Bedroom 3

2.96m × 2.52m 9' 9" × 8' 3"

[→ Discover more about this home](#)

[→ View our current availability](#)

*This window is plot specific, please speak to our Sales Executive for further details. The floor plans depict a typical layout of this house type. For exact plot specification, details of external and internal finishes, dimensions and floor plan differences consult your sales executive. All dimensions are + or - 50mm and floor plans are not shown to scale. The kitchen layout and furniture positions are for indicative purposes only. The computer generated image is for illustrative purposes only and it is from an imaginary viewpoint within an open space area. Its purpose is to give a feel for the development, not an accurate description of each property. The illustration shows a typical Taylor Wimpey home of this type, but there are, however, variances from site to site. External materials, finishes, landscaping and the position of garages (where provided) may vary throughout the development. Properties may also be built handed (mirror image). Images may include optional upgrades at an additional cost. Please ask for further details, TWNE 75242 / August 2024



The Aynesdale

3 BEDROOM HOME, TOTAL 1,073 sq ft / 98.0m²



GROUND FLOOR

Living/Study

3.19m × 5.52m 10' 6" × 18' 1"

Kitchen/Dining

3.21m × 5.52m 10' 6" × 18' 1"



FIRST FLOOR

Bedroom 1 max.

3.36m × 4.51m 11' 0" × 14' 10"

Bedroom 2

3.27m × 3.23m 10' 9" × 10' 7"

Bedroom 3

2.80m × 2.66m 9' 2" × 8' 9"

[→ Discover more about this home](#)

[→ View our current availability](#)

*This window is plot specific, please speak to our Sales Executive for further details. The floor plans depict a typical layout of this house type. For exact plot specification, details of external and internal finishes, dimensions and floor plan differences consult your sales executive. All dimensions are + or - 50mm and floor plans are not shown to scale. The kitchen layout and furniture positions are for indicative purposes only. The computer generated image is for illustrative purposes only and it is from an imaginary viewpoint within an open space area. Its purpose is to give a feel for the development, not an accurate description of each property. The illustration shows a typical Taylor Wimpey home of this type, but there are, however, variances from site to site. External materials, finishes, landscaping and the position of garages (where provided) may vary throughout the development. Properties may also be built handed (mirror image). Images may include optional upgrades at an additional cost. Please ask for further details, TWNE 75242 / August 2024



The Byrneham

3 BEDROOM HOME, TOTAL 1,154 sq ft / 105.0m²



GROUND FLOOR

Lounge

4.17m × 4.37m 13' 8" × 14' 4"

Kitchen/Dining

4.39m × 4.17m 14' 5" × 13' 8"



FIRST FLOOR

Bedroom 1

5.32m × 3.22m 17' 6" × 10' 9"

Bedroom 2

2.89m × 4.17m 9' 6" × 13' 8"

Bedroom 3

3.59m × 2.23m 11' 10" × 7' 4"

[→ Discover more about this home](#)

[→ View our current availability](#)

*This window is plot specific, please speak to our Sales Executive for further details. The floor plans depict a typical layout of this house type. For exact plot specification, details of external and internal finishes, dimensions and floor plan differences consult your sales executive. All dimensions are + or - 50mm and floor plans are not shown to scale. The kitchen layout and furniture positions are for indicative purposes only. The computer generated image is for illustrative purposes only and it is from an imaginary viewpoint within an open space area. Its purpose is to give a feel for the development, not an accurate description of each property. The illustration shows a typical Taylor Wimpey home of this type, but there are, however, variances from site to site. External materials, finishes, landscaping and the position of garages (where provided) may vary throughout the development. Properties may also be built handed (mirror image). Images may include optional upgrades at an additional cost. Please ask for further details, TWNE 75242 / August 2024



The Carrdale

3 BEDROOM HOME, TOTAL 1,073 sq ft / 98.0m²



GROUND FLOOR

Living room/Study

5.52m × 3.19m 18' 1" × 10' 6"

Kitchen

3.21m × 5.52m 10' 6" × 18' 1"

Dining

2.70m × 3.21m 8' 11" × 10' 6"



FIRST FLOOR

Bedroom 1

2.75m × 3.36m 9' 0" × 11' 0"

Bedroom 2

3.23m × 3.27m 10' 7" × 10' 9"

Bedroom 3

2.68m × 2.79m 8' 10" × 9' 2"

[→ Discover more about this home](#)

[→ View our current availability](#)

*This window is plot specific, please speak to our Sales Executive for further details. The floor plans depict a typical layout of this house type. For exact plot specification, details of external and internal finishes, dimensions and floor plan differences consult your sales executive. All dimensions are + or - 50mm and floor plans are not shown to scale. The kitchen layout and furniture positions are for indicative purposes only. The computer generated image is for illustrative purposes only and it is from an imaginary viewpoint within an open space area. Its purpose is to give a feel for the development, not an accurate description of each property. The illustration shows a typical Taylor Wimpey home of this type, but there are, however, variances from site to site. External materials, finishes, landscaping and the position of garages (where provided) may vary throughout the development. Properties may also be built handed (mirror image). Images may include optional upgrades at an additional cost. Please ask for further details, TWNE 75242 / August 2024



The Ambleford

3 BEDROOM HOME, TOTAL 813 sq ft / 74.0m²



GROUND FLOOR

Living room		
4.02m × 3.27m		13' 3" × 10' 9"
<hr/>		
Kitchen/Dining		
2.94m × 4.17m		9' 8" × 13' 8"



FIRST FLOOR

Bedroom 1		
2.90m × 4.17m		9' 6" × 13' 8"
<hr/>		
Bedroom 2		
3.59m × 2.30m		11' 9" × 7' 7"
<hr/>		
Bedroom 3		
2.56m × 1.78m		8' 5" × 5' 10"

[→ Discover more about this home](#)

[→ View our current availability](#)

*This window is plot specific, please speak to our Sales Executive for further details. The floor plans depict a typical layout of this house type. For exact plot specification, details of external and internal finishes, dimensions and floor plan differences consult your sales executive. All dimensions are + or - 50mm and floor plans are not shown to scale. The kitchen layout and furniture positions are for indicative purposes only. The computer generated image is for illustrative purposes only and it is from an imaginary viewpoint within an open space area. Its purpose is to give a feel for the development, not an accurate description of each property. The illustration shows a typical Taylor Wimpey home of this type, but there are, however, variances from site to site. External materials, finishes, landscaping and the position of garages (where provided) may vary throughout the development. Properties may also be built handed (mirror image). Images may include optional upgrades at an additional cost. Please ask for further details, TWNE 75242 / August 2024



The Eynsford

3 BEDROOM HOME, TOTAL 972 sq ft / 90.0m²



GROUND FLOOR

Lounge

4.37m × 3.43m 13' 8" × 11' 3"

Kitchen/Dining

3.80m × 5.10m 12' 6" × 16' 8"



FIRST FLOOR

Bedroom 1

4.03m × 3.01m 13' 3" × 9' 11"

Bedroom 2

2.15m × 3.47m 7' 1" × 11' 5"

Bedroom 3

2.83m × 2.92m 9' 4" × 9' 7"

[→ Discover more about this home](#)

[→ View our current availability](#)

*This window is plot specific, please speak to our Sales Executive for further details. The floor plans depict a typical layout of this house type. For exact plot specification, details of external and internal finishes, dimensions and floor plan differences consult your sales executive. All dimensions are + or - 50mm and floor plans are not shown to scale. The kitchen layout and furniture positions are for indicative purposes only. The computer generated image is for illustrative purposes only and it is from an imaginary viewpoint within an open space area. Its purpose is to give a feel for the development, not an accurate description of each property. The illustration shows a typical Taylor Wimpey home of this type, but there are, however, variances from site to site. External materials, finishes, landscaping and the position of garages (where provided) may vary throughout the development. Properties may also be built handed (mirror image). Images may include optional upgrades at an additional cost. Please ask for further details, TWNE 75242 / August 2024



The Beaford

2 BEDROOM HOME, TOTAL 792 sq ft / 72.0m²



GROUND FLOOR

Lounge/Dining

3.80m x 4.00m 12' 6" x 13' 4"

Kitchen

2.18m x 2.92m 7' 2" x 9' 7"



FIRST FLOOR

Bedroom 1

3.79m x 4.10m 12' 5" x 13' 4"

Bedroom 2

2.69m x 4.10m 8' 10" x 13' 4"

[→ Discover more about this home](#)

[→ View our current availability](#)

*This window is plot specific, please speak to our Sales Executive for further details. The floor plans depict a typical layout of this house type. For exact plot specification, details of external and internal finishes, dimensions and floor plan differences consult your sales executive. All dimensions are + or - 50mm and floor plans are not shown to scale. The kitchen layout and furniture positions are for indicative purposes only. The computer generated image is for illustrative purposes only and it is from an imaginary viewpoint within an open space area. Its purpose is to give a feel for the development, not an accurate description of each property. The illustration shows a typical Taylor Wimpey home of this type, but there are, however, variances from site to site. External materials, finishes, landscaping and the position of garages (where provided) may vary throughout the development. Properties may also be built handed (mirror image). Images may include optional upgrades at an additional cost. Please ask for further details, TWNE 75242 / August 2024

Ways to buy

Everyone knows buying a new home is an exciting time. But it can be a stressful one too, which is why our sales executives and customer relations managers are there to help every step of the way, from your initial enquiry right through to opening the front door of your new home for the first time.



First time buyer?

→ Here's how we can help

Existing home owner?

→ Here's how we can help



Take your next step



Find your dream home on our website.



Book an appointment to view our show homes.



Take a virtual tour of our homes from the comfort of your sofa.



Have your questions answered by calling our sales executives on **01670 468 348.**



Find out how we can get you moving with our buying schemes.

[→ Book an appointment](#)

[→ How to buy a home](#)



GREENDALE PARK Choppington Road, Bedlington, Northumberland, NE22 6LA

CONTACT US ON 01670 468 348

Taylor Wimpey

Taylor Wimpey in their efforts to improve designs reserve the right to alter site plans, floor plans, elevations and specifications without notice. All lifestyle and location imagery used within this brochure is indicative only. Taylor Wimpey houses are sold freehold and apartments are sold leasehold. Please see the development page on our website for further details. For terms and conditions on our schemes and incentives including Help to Buy, Part Exchange and easymover, go to www.taylorwimpey.co.uk/terms. Information is correct at the time of going to print. Please speak to your sales executive for further details.