



Kingsbourne

NANTWICH, CHESHIRE

Kingsbourne is a collection of stunning
2 bedroom apartments and 2, 3, 4 & 5 bedroom new homes
in the beautiful Cheshire town of Nantwich.

Taylor
Wimpey

Contents



**Welcome to
Kingsbourne**

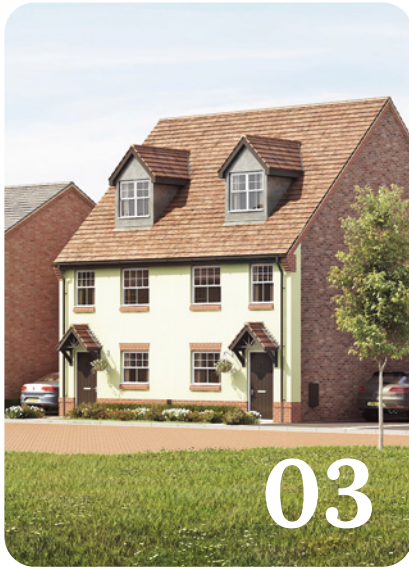

**Personalise
your home**

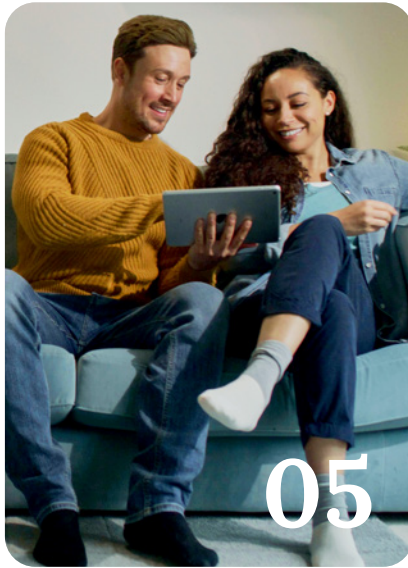

**Included
as standard**



Our homes



Ways to buy



**Take your
next step**



Welcome to Kingsbourne

A beautiful collection of 2 bedroom apartments and
2, 3, 4 & 5 bedroom detached and semi-detached homes
in the heart of the market town of Nantwich.



[→ View the site plan](#)

This computer generated image is for illustrative purposes only. Its purpose is to give a feel for the development, not an accurate description of each property. Please enquire for further details.

Enjoy convenient living

Set in the heart of the medieval market town of Nantwich, Kingsbourne is surrounded by the rolling Cheshire countryside as well as being nearby to the River Weaver.

The charming town centre is lined with a striking collection of grade I and II listed buildings and is home to a bustling market place, antique dealers, independent boutiques and quaint cafes.

Local countryside



Stunning traditional architecture still remains around the town



Enjoy a stroll around the calm town centre



Personalise your home

A new Taylor Wimpey home is a blank canvas, ready for you to put your stamp on even before you move in. You can choose from a range of high quality options for your kitchen, bedroom and bathroom to suit your taste – and all from the comfort of your sofa. We offer dark and light kitchen units and patterned or plain tiles for your bathroom, so whatever your preferred style we've got you covered.

Using our innovative Options Online tool, you can visualise your new home room-by-room and customise each as you go. You can also choose your options with the help of your Sales Executive if you'd prefer.

Our customers have created some fantastic spaces in their homes and you can get inspiration from their choices by following us on Instagram. You can also check out a host of interior design tips on our website.



Find out more



Options availability is subject to build stage of plots and options won't be available if plots have reached a certain build stage. Please contact the Sales Executive for further information.

Included as standard

From the external features to the finishing touches, every detail of our homes is designed with our customers in mind.

While you'll have the choice to upgrade some of our standard offerings, all of our houses are fitted with a range of high quality features at no extra cost to you.

You'll find a complete list of all items that come as standard in your house below.



Kitchens

All of our kitchens are fitted with beautiful units and worktops and you can choose your preferred style and colour to create your perfect cooking and entertaining space.

A range of accessories including stylish splashbacks, a stainless steel sink and Zeno Taps, and lighting give your kitchen a clean, contemporary finish. You'll get a modern, energy efficient Zanussi oven with built-in gas hob and integrated hood and extractor fan too.

Utility rooms[†]

Units will be fitted to match your chosen kitchen style, complete with a stainless steel sink and Zeno Taps. If your home has a toilet in the utility room, we'll fit a contemporary white basin and toilet for a sleek finish.



Bathrooms, en suites and shower rooms

Modern white sanitaryware, including toilet, basin and bath with chrome Ideal Standard taps give your main bathroom a clean look. The same sanitaryware is fitted in en suites and shower rooms which also benefit from an Aqualisa shower and glass enclosure. For a distinct look, we offer a varied range of Porcelanosa ceramic wall tiles for you to choose from to make your bathroom and en suite stand out from the crowd.



Garden[†]

The outside of your home is just as carefully considered as the inside. You'll get a fully turfed and landscaped front garden – including plants. The back garden includes a slabbed area and your privacy is protected by a garden fence.



All of the specification listed is included in our houses as standard. For the specification included in our apartments, please see the separate apartment specification list. Standard specifications are correct at time of going to print, but are subject to change without notice. Please contact the Sales Executive for further information. [†] = Where applicable.

Specification of our houses

	Ashenford	Gosford	Milldale	Easedale	Amersham	Braxton	Lydford	Trusdale	Coltham	Manford	Felton
Kitchens											
Fitted kitchen with choice of door fronts (please refer to working drawings for layout details)	✓	✓	✓	✓	✓	✓	✓	✓	✓	✓	✓
Choice of laminate worktops with matching upstand from our standard selection	✓	✓	✓	✓	✓	✓	✓	✓	✓	✓	✓
Integrated cooker hood	✓	✓	✓	✓	✓	✓	✓	✓	✓	✓	✓
Stainless steel oven	✓	✓	✓	✓	✓	✓	✓	✓	✓	✓	✓
Stainless steel gas hob	✓	✓	✓	✓	✓	✓	✓	✓	✓	✓	✓
Stainless steel splashback to hob	✓	✓	✓	✓	✓	✓	✓	✓	✓	✓	✓
Integrated tall fridge freezer							✓	✓	✓	✓	✓
Integrated dishwasher							✓	✓	✓	✓	✓
Integrated washing machine							✓	✓	✓	✓	✓
Bathrooms, En suites & Cloakrooms											
Ideal Standard chrome taps (where applicable)	✓	✓	✓	✓	✓	✓	✓	✓	✓	✓	✓
WC - Choice of splash back tiling from standard range (please refer to drawings)	✓	✓	✓	✓	✓	✓	✓	✓	✓	✓	✓
Bathroom - Choice of half height tiling from standard range (please refer to drawings)	✓	✓	✓	✓	✓	✓	✓	✓	✓	✓	✓
En suites - Choice of half height tiling from standard range (full height to shower areas)		✓	✓	✓	✓	✓	✓	✓	✓	✓	✓
Modern free standing bathroom suite	✓	✓	✓	✓	✓	✓	✓	✓	✓	✓	✓
Mechanical extraction in bathroom, en suites, kitchens, utility rooms and cloaks (with no opening windows)	✓	✓	✓	✓	✓	✓	✓	✓	✓	✓	✓
Shower in en-suite (please refer to the Sales Executive for more details)		✓	✓	✓	✓	✓	✓	✓	✓	✓	✓
Central Heating/Hot Water System											
Fully programmable central heating providing hot water	✓	✓	✓	✓	✓	✓	✓	✓	✓	✓	✓
White thermostatic radiators	✓	✓	✓	✓	✓	✓	✓	✓	✓	✓	✓
Mains pressure hot water system	✓	✓	✓	✓	✓	✓	✓	✓	✓	✓	✓
Cavity wall insulation in line with Building Regulations	✓	✓	✓	✓	✓	✓	✓	✓	✓	✓	✓
Loft insulation in line with Building Regulations	✓	✓	✓	✓	✓	✓	✓	✓	✓	✓	✓

✓ = Standard features * = Options, upgrades and colour choices are available subject to stage of construction † = Where applicable

All of the specification listed is included in our houses as standard. For the specification included in our apartments, please see the separate apartment specification list. Recent changes in building regulations may affect the energy performance calculation on some new build homes. This means that the addition of a shower over a bath as an upgrade may no longer be available on selected homes. Please speak to our Sales Executive to find out more. Standard specifications are correct at time of going to print, but are subject to change without notice.

Please contact the Sales Executive for further information.

Specification of our houses

	Ashenford	Gosford	Milledale	Easedale	Amersham	Braxton	Lydford	Trusdale	Coltham	Manford	Felton
Electrical Features											
Power points in line with NHBC requirements	✓	✓	✓	✓	✓	✓	✓	✓	✓	✓	✓
TV socket to lounge and master bedroom*	✓	✓	✓	✓	✓	✓	✓	✓	✓	✓	✓
Master telephone socket to lounge	✓	✓	✓	✓	✓	✓	✓	✓	✓	✓	✓
USB/double socket in kitchen (refer to drawings for location)	✓	✓	✓	✓	✓	✓	✓	✓	✓	✓	✓
Power and lighting to garages							✓	✓	✓	✓	✓
Windows, Doors & Joinery											
White PVCu window frames and French doors with multi point locking system (where applicable)	✓	✓	✓	✓	✓	✓	✓	✓	✓	✓	✓
GRP front door with key/thumbturn multi-point lock, chrome furniture, letter plate, viewer and chain - various designs as finishes schedule	✓	✓	✓	✓	✓	✓	✓	✓	✓	✓	✓
Steel pre-finished garage door (colour as indicated on finishes schedule)							✓	✓	✓	✓	✓
'Newark' white finished 5 panel internal doors with chrome ironmongery		✓	✓	✓	✓	✓	✓	✓	✓	✓	✓
Finishing Touches											
Flat white finish to ceilings	✓	✓	✓	✓	✓	✓	✓	✓	✓	✓	✓
Emulsion paint to walls (please refer to Sales Executive for details)	✓	✓	✓	✓	✓	✓	✓	✓	✓	✓	✓
White gloss to all joinery e.g. skirting boards and door architraves	✓	✓	✓	✓	✓	✓	✓	✓	✓	✓	✓
Internal Features											
Mains operated smoke detectors to each floor	✓	✓	✓	✓	✓	✓	✓	✓	✓	✓	✓
Carbon monoxide detector	✓	✓	✓	✓	✓	✓	✓	✓	✓	✓	✓
Fitted wardrobes with mirrored sliding doors to master bedroom							✓	✓	✓	✓	✓
External Features											
Door number plate	✓	✓	✓	✓	✓	✓	✓	✓	✓	✓	✓
Coach light to front	✓	✓	✓	✓	✓	✓	✓	✓	✓	✓	✓
Gardens, Paths and Drives											
Front/side garden turfed – Landscaped as per approved drawings (weather permitting)	✓	✓	✓	✓	✓	✓	✓	✓	✓	✓	✓
1.8m high close board fence to rear/sides	✓	✓	✓	✓	✓	✓	✓	✓	✓	✓	✓
Outside tap to rear/side of property	✓	✓	✓	✓	✓	✓	✓	✓	✓	✓	✓
NHBC 10-year Warranty	✓	✓	✓	✓	✓	✓	✓	✓	✓	✓	✓
Taylor Wimpey warranty for 2 years from date of legal completion	✓	✓	✓	✓	✓	✓	✓	✓	✓	✓	✓

✓ = Standard features * = Options, upgrades and colour choices are available subject to stage of construction † = Where applicable

All of the specification listed is included in our houses as standard. For the specification included in our apartments, please see the separate apartment specification list. Recent changes in building regulations may affect the energy performance calculation on some new build homes. This means that the addition of a shower over a bath as an upgrade may no longer be available on selected homes. Please speak to our Sales Executive to find out more. Standard specifications are correct at time of going to print, but are subject to change without notice. Please contact the Sales Executive for further information.

Our homes

→ 2 bedroom homes



→ 3 bedroom homes



→ 4 bedroom homes



→ 5 bedroom homes



→ View the site plan



The Ashenford

2 BEDROOM HOME, TOTAL NET 755 SQ FT



GROUND FLOOR

Lounge/Dining

4.31m x 4.02m 14' 2" x 13' 2"

Kitchen

2.11m x 2.74m 6' 11" x 9' 0"



FIRST FLOOR

Bedroom 1

3.63m x 3.27m 11' 11" x 10' 9"

Bedroom 2 max.

4.31m x 2.51m 14' 2" x 8' 3"



[View development](#)

*Plot specific windows. The floor plans depict a typical layout of this house type. For exact plot specification, details of external and internal finishes, dimensions and floor plan differences consult your sales executive. The sq ft/ sq m stated is the net sales area described in the RICS Code of Measurement 6th Edition. It is the area of the building measured to the plaster finish of the perimeter walls at each floor level. The measurement includes internal walls, service boxings and voids over stairs. It excludes internal garages and areas with less than 1.5m headroom. All dimensions are + or - 50mm and floor plans are not shown to scale. The kitchen layout and furniture positions are for indicative purposes only. The computer generated image is for illustrative purposes only and it is from an imaginary viewpoint within an open space area. Its purpose is to give a feel for the development, not an accurate description of each property. The illustration shows a typical Taylor Wimpey home of this type, but there are, however, variances from site to site. External materials, finishes, landscaping and the position of garages (where provided) may vary throughout the development. Properties may also be built handed (mirror image). Images may include optional upgrades at an additional cost. Please ask for further details.TWNW 81900 / January 2025.



The Alton G

3 BEDROOM HOME, TOTAL NET 1,081 SQ FT



GROUND FLOOR

Lounge

4.23m x 3.49m 13' 11" x 11' 6"

Kitchen/Dining

5.26m x 3.20m 17' 3" x 10' 6"



FIRST FLOOR

Bedroom 2 max.

4.23m x 3.49m 13' 11" x 11' 6"

Bedroom 3

3.28m x 2.17m 10' 9" x 7' 2"



SECOND FLOOR

Bedroom 1 max. ex. dormer

6.70m x 3.11m 22' 0" x 10' 3"



Discover more about this home



View development

*Plot specific windows. The floor plans depict a typical layout of this house type. For exact plot specification, details of external and internal finishes, dimensions and floor plan differences consult your sales executive. The sq ft/ sq m stated is the net sales area described in the RICS Code of Measurement 6th Edition. It is the area of the building measured to the plaster finish of the perimeter walls at each floor level. The measurement includes internal walls, service boxings and voids over stairs. It excludes internal garages and areas with less than 1.5m headroom. All dimensions are + or - 50mm and floor plans are not shown to scale. The kitchen layout and furniture positions are for indicative purposes only. The computer generated image is for illustrative purposes only and it is from an imaginary viewpoint within an open space area. Its purpose is to give a feel for the development, not an accurate description of each property. The illustration shows a typical Taylor Wimpey home of this type, but there are, however, variances from site to site. External materials, finishes, landscaping and the position of garages (where provided) may vary throughout the development. Properties may also be built handed (mirror image). Images may include optional upgrades at an additional cost. Please ask for further details.TWNW 81900 / January 2025.



The Milldale

3 BEDROOM HOME, TOTAL NET 1,227 SQ FT



GROUND FLOOR

Lounge

4.62m x 3.34m 15' 2" x 10' 11"

Kitchen/Dining

4.62m x 2.96m 15' 2" x 9' 9"



FIRST FLOOR

Bedroom 1

3.33m x 2.83m 10' 11" x 9' 3"

Bedroom 2

3.03m x 2.61m 9' 11" x 8' 4"

Bedroom 3

3.03m x 1.97m 9' 11" x 6' 3"



Discover more about this home



View development

*Plot specific windows. The floor plans depict a typical layout of this house type. For exact plot specification, details of external and internal finishes, dimensions and floor plan differences consult your sales executive. The sq ft/ sq m stated is the net sales area described in the RICS Code of Measurement 6th Edition. It is the area of the building measured to the plaster finish of the perimeter walls at each floor level. The measurement includes internal walls, service boxings and voids over stairs. It excludes internal garages and areas with less than 1.5m headroom. All dimensions are + or - 50mm and floor plans are not shown to scale. The kitchen layout and furniture positions are for indicative purposes only. The computer generated image is for illustrative purposes only and it is from an imaginary viewpoint within an open space area. Its purpose is to give a feel for the development, not an accurate description of each property. The illustration shows a typical Taylor Wimpey home of this type, but there are, however, variances from site to site. External materials, finishes, landscaping and the position of garages (where provided) may vary throughout the development. Properties may also be built handed (mirror image). Images may include optional upgrades at an additional cost. Please ask for further details.TWNW 81900 / January 2025.



The Gosford

3 BEDROOM HOME, TOTAL NET 852 SQ FT



GROUND FLOOR

Lounge

4.26m × 3.69m 14' 0" × 12' 1"

Kitchen/Dining

4.72m × 2.87m 15' 6" × 9' 5"

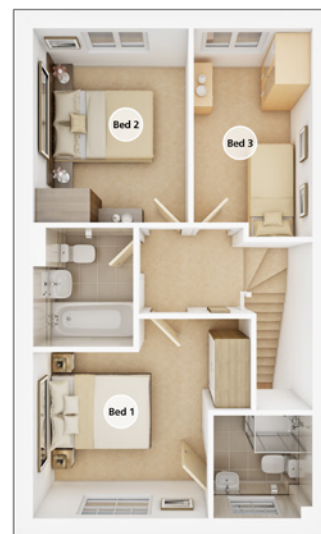

FIRST FLOOR

Bedroom 1 min.

2.96m × 2.83m 9' 9" × 9' 4"

Bedroom 2

3.30m × 2.63m 10' 10" × 8' 8"

Bedroom 3

3.55m × 2.00m 11' 8" × 6' 7"



[Discover more about this home](#)



[View development](#)

*Plot specific windows. The floor plans depict a typical layout of this house type. For exact plot specification, details of external and internal finishes, dimensions and floor plan differences consult your sales executive. The sq ft/ sq m stated is the net sales area described in the RICS Code of Measurement 6th Edition. It is the area of the building measured to the plaster finish of the perimeter walls at each floor level. The measurement includes internal walls, service boxings and voids over stairs. It excludes internal garages and areas with less than 1.5m headroom. All dimensions are + or - 50mm and floor plans are not shown to scale. The kitchen layout and furniture positions are for indicative purposes only. The computer generated image is for illustrative purposes only and it is from an imaginary viewpoint within an open space area. Its purpose is to give a feel for the development, not an accurate description of each property. The illustration shows a typical Taylor Wimpey home of this type, but there are, however, variances from site to site. External materials, finishes, landscaping and the position of garages (where provided) may vary throughout the development. Properties may also be built handed (mirror image). Images may include optional upgrades at an additional cost. Please ask for further details.TWNW 81900 / January 2025.



The Braxton

3 BEDROOM HOME, TOTAL NET 1,070 SQ FT



GROUND FLOOR

Lounge min.

2.44m x 4.19m 8' 0" x 13' 9"

Kitchen/Dining max.

4.25m x 3.43m 14' 0" x 11' 3"



FIRST FLOOR

Bedroom 2 max.

4.25m x 2.82m 14' 0" x 9' 3"

Bedroom 3

2.11m x 3.59m 6' 11" x 11' 10"



SECOND FLOOR

Bedroom 1 max.

2.76m x 6.64m 9' 1" x 21' 10"



Discover more about this home



View development

*Plot specific windows. The floor plans depict a typical layout of this house type. For exact plot specification, details of external and internal finishes, dimensions and floor plan differences consult your sales executive. The sq ft/ sq m stated is the net sales area described in the RICS Code of Measurement 6th Edition. It is the area of the building measured to the plaster finish of the perimeter walls at each floor level. The measurement includes internal walls, service boxings and voids over stairs. It excludes internal garages and areas with less than 1.5m headroom. All dimensions are + or - 50mm and floor plans are not shown to scale. The kitchen layout and furniture positions are for indicative purposes only. The computer generated image is for illustrative purposes only and it is from an imaginary viewpoint within an open space area. Its purpose is to give a feel for the development, not an accurate description of each property. The illustration shows a typical Taylor Wimpey home of this type, but there are, however, variances from site to site. External materials, finishes, landscaping and the position of garages (where provided) may vary throughout the development. Properties may also be built handed (mirror image). Images may include optional upgrades at an additional cost. Please ask for further details.TWNW 81900 / January 2025.



The Amersham

3 BEDROOM HOME, TOTAL NET 975 SQ FT



GROUND FLOOR

Lounge

2.88m × 4.03m 9' 6" × 13' 3"

Kitchen/Dining min.

4.37m × 2.88m 14' 4" × 9' 5"



FIRST FLOOR

Bedroom 1

3.21m × 4.21m 10' 6" × 13' 10"

Bedroom 2 max.

4.37m × 3.08m 14' 4" × 9' 11"

Bedroom 3 max.

2.90m × 2.89m 9' 6" × 9' 6"

Study

2.22m × 1.67m 7' 4" × 5' 6"



Discover more about this home



View development

*Plot specific windows. The floor plans depict a typical layout of this house type. For exact plot specification, details of external and internal finishes, dimensions and floor plan differences consult your sales executive. The sq ft/ sq m stated is the net sales area described in the RICS Code of Measurement 6th Edition. It is the area of the building measured to the plaster finish of the perimeter walls at each floor level. The measurement includes internal walls, service boxings and voids over stairs. It excludes internal garages and areas with less than 1.5m headroom. All dimensions are + or - 50mm and floor plans are not shown to scale. The kitchen layout and furniture positions are for indicative purposes only. The computer generated image is for illustrative purposes only and it is from an imaginary viewpoint within an open space area. Its purpose is to give a feel for the development, not an accurate description of each property. The illustration shows a typical Taylor Wimpey home of this type, but there are, however, variances from site to site. External materials, finishes, landscaping and the position of garages (where provided) may vary throughout the development. Properties may also be built handed (mirror image). Images may include optional upgrades at an additional cost. Please ask for further details.TWNW 81900 / January 2025.



The Easedale

3 BEDROOM HOME, TOTAL NET 917 SQ FT



GROUND FLOOR

Lounge

5.10m x 3.02m 16' 9" x 9' 11"

Kitchen/Dining max..

5.10m x 2.95m 16' 9" x 9' 8"



FIRST FLOOR

Bedroom 1

3.78m x 3.08m 12' 5" x 10' 1"

Bedroom 2

3.02m x 2.86m 9' 11" x 9' 5"

Bedroom 3

3.02m x 2.15m 9' 11" x 7' 1"



Discover more about this home



View development

*Plot specific windows. The floor plans depict a typical layout of this house type. For exact plot specification, details of external and internal finishes, dimensions and floor plan differences consult your sales executive. The sq ft/ sq m stated is the net sales area described in the RICS Code of Measurement 6th Edition. It is the area of the building measured to the plaster finish of the perimeter walls at each floor level. The measurement includes internal walls, service boxings and voids over stairs. It excludes internal garages and areas with less than 1.5m headroom. All dimensions are + or - 50mm and floor plans are not shown to scale. The kitchen layout and furniture positions are for indicative purposes only. The computer generated image is for illustrative purposes only and it is from an imaginary viewpoint within an open space area. Its purpose is to give a feel for the development, not an accurate description of each property. The illustration shows a typical Taylor Wimpey home of this type, but there are, however, variances from site to site. External materials, finishes, landscaping and the position of garages (where provided) may vary throughout the development. Properties may also be built handed (mirror image). Images may include optional upgrades at an additional cost. Please ask for further details.TWNW 81900 / January 2025.



The Shelford

4 BEDROOM HOME, TOTAL NET 1,281 SQ FT



GROUND FLOOR

Lounge

4.74m x 3.88m 15' 7" x 12' 9"

Kitchen/Dining max.

8.10m x 3.24m 26' 7" x 10' 8"

Study

2.64m x 2.10m 8' 8" x 6' 11"



FIRST FLOOR

Bedroom 1 max.

3.88m x 3.76m 12' 9" x 12' 4"

Bedroom 2 max.

4.22m x 3.07m 13' 10" x 10' 1"

Bedroom 3 max.

3.43m x 3.09m 11' 3" x 10' 2"

Bedroom 4 max.

3.89m x 2.75m 12' 9" x 9' 0"



Discover more about this home



View development

*Plot specific windows. The floor plans depict a typical layout of this house type. For exact plot specification, details of external and internal finishes, dimensions and floor plan differences consult your sales executive. The sq ft/ sq m stated is the net sales area described in the RICS Code of Measurement 6th Edition. It is the area of the building measured to the plaster finish of the perimeter walls at each floor level. The measurement includes internal walls, service boxings and voids over stairs. It excludes internal garages and areas with less than 1.5m headroom. All dimensions are + or - 50mm and floor plans are not shown to scale. The kitchen layout and furniture positions are for indicative purposes only. The computer generated image is for illustrative purposes only and it is from an imaginary viewpoint within an open space area. Its purpose is to give a feel for the development, not an accurate description of each property. The illustration shows a typical Taylor Wimpey home of this type, but there are, however, variances from site to site. External materials, finishes, landscaping and the position of garages (where provided) may vary throughout the development. Properties may also be built handed (mirror image). Images may include optional upgrades at an additional cost. Please ask for further details.TWNW 81900 / January 2025.



The Teasdale

4 BEDROOM HOME, TOTAL NET 1,272 SQ FT



GROUND FLOOR

Lounge

4.77m × 3.61m 15' 8" × 11' 10"

Study

2.94m × 2.70m 10' 9" × 7' 2"

Kitchen/Dining max.

5.81m × 3.07m 19' 1" × 10' 1"



FIRST FLOOR

Bedroom 1

3.67m × 3.57m 12' 1" × 11' 9"

Bedroom 2 max.

4.06m × 2.73m 13' 4" × 8' 11"

Bedroom 3

2.83m × 2.71m 9' 4" × 8' 11"

Bedroom 4 max.

2.63m × 1.90m 8' 8" × 6' 3"



[View development](#)

*Plot specific windows. The floor plans depict a typical layout of this house type. For exact plot specification, details of external and internal finishes, dimensions and floor plan differences consult your sales executive. The sq ft/ sq m stated is the net sales area described in the RICS Code of Measurement 6th Edition. It is the area of the building measured to the plaster finish of the perimeter walls at each floor level. The measurement includes internal walls, service boxings and voids over stairs. It excludes internal garages and areas with less than 1.5m headroom. All dimensions are + or - 50mm and floor plans are not shown to scale. The kitchen layout and furniture positions are for indicative purposes only. The computer generated image is for illustrative purposes only and it is from an imaginary viewpoint within an open space area. Its purpose is to give a feel for the development, not an accurate description of each property. The illustration shows a typical Taylor Wimpey home of this type, but there are, however, variances from site to site. External materials, finishes, landscaping and the position of garages (where provided) may vary throughout the development. Properties may also be built handed (mirror image). Images may include optional upgrades at an additional cost. Please ask for further details.TWNW 81900 / January 2025.



The Evesham

4 BEDROOM HOME, TOTAL NET 1,227 SQ FT



GROUND FLOOR

Lounge

3.84m x 4.54m 12' 7" x 14' 11"

Kitchen/Dining

5.39m x 2.86m 17' 8" x 9' 5"



FIRST FLOOR

Bedroom 1 max.

3.84m x 3.54m 12' 7" x 14' 11"

Bedroom 2 min.

3.25m x 3.33m 10' 8" x 10' 11"

Bedroom 3

3.16m x 2.89m 10' 5" x 9' 6"

Bedroom 4 min.

2.77m x 2.64m 9' 1" x 8' 1"



[View development](#)

*Plot specific windows. The floor plans depict a typical layout of this house type. For exact plot specification, details of external and internal finishes, dimensions and floor plan differences consult your sales executive. The sq ft/ sq m stated is the net sales area described in the RICS Code of Measurement 6th Edition. It is the area of the building measured to the plaster finish of the perimeter walls at each floor level. The measurement includes internal walls, service boxings and voids over stairs. It excludes internal garages and areas with less than 1.5m headroom. All dimensions are + or - 50mm and floor plans are not shown to scale. The kitchen layout and furniture positions are for indicative purposes only. The computer generated image is for illustrative purposes only and it is from an imaginary viewpoint within an open space area. Its purpose is to give a feel for the development, not an accurate description of each property. The illustration shows a typical Taylor Wimpey home of this type, but there are, however, variances from site to site. External materials, finishes, landscaping and the position of garages (where provided) may vary throughout the development. Properties may also be built handed (mirror image). Images may include optional upgrades at an additional cost. Please ask for further details.TWNW 81900 / January 2025.



The Coltham

4 BEDROOM HOME, TOTAL NET 1,241 SQ FT



GROUND FLOOR

Lounge

3.84m × 4.53m 12' 7" × 14' 11"

Kitchen/Dining

5.39m × 2.86m 17' 8" × 9' 5"



FIRST FLOOR

Bedroom 1

3.84m × 3.10m 12' 7" × 10' 2"

Bedroom 2

3.66m × 3.15m 12' 0" × 10' 4"

Bedroom 3

3.33m × 3.40m 10' 11" × 11' 2"

Bedroom 4

2.58m × 2.88m 8' 6" × 9' 6"



Discover more about this home



View development

*Plot specific windows. The floor plans depict a typical layout of this house type. For exact plot specification, details of external and internal finishes, dimensions and floor plan differences consult your sales executive. The sq ft/ sq m stated is the net sales area described in the RICS Code of Measurement 6th Edition. It is the area of the building measured to the plaster finish of the perimeter walls at each floor level. The measurement includes internal walls, service boxings and voids over stairs. It excludes internal garages and areas with less than 1.5m headroom. All dimensions are + or - 50mm and floor plans are not shown to scale. The kitchen layout and furniture positions are for indicative purposes only. The computer generated image is for illustrative purposes only and it is from an imaginary viewpoint within an open space area. Its purpose is to give a feel for the development, not an accurate description of each property. The illustration shows a typical Taylor Wimpey home of this type, but there are, however, variances from site to site. External materials, finishes, landscaping and the position of garages (where provided) may vary throughout the development. Properties may also be built handed (mirror image). Images may include optional upgrades at an additional cost. Please ask for further details.TWNW 81900 / January 2025.



The Manford

4 BEDROOM HOME, TOTAL NET 1,368 SQ FT



GROUND FLOOR

Lounge

3.88m x 4.74m 12' 9" x 15' 7"

Kitchen/Dining

8.11m x 3.26m 26' 7" x 10' 9"

Study

2.10m x 2.61m 6' 11" x 8' 7"



FIRST FLOOR

Bedroom 1 max.

3.88m x 3.71m 12' 9" x 12' 2"

Bedroom 2 max.

3.09m x 4.02m 10' 2" x 13' 2"

Bedroom 3 max.

3.03m x 3.66m 10' 0" x 12' 0"

Bedroom 4 max.

2.75m x 3.97m 9' 0" x 13' 0"



Discover more about this home



View development

*Plot specific windows. The floor plans depict a typical layout of this house type. For exact plot specification, details of external and internal finishes, dimensions and floor plan differences consult your sales executive. The sq ft/ sq m stated is the net sales area described in the RICS Code of Measurement 6th Edition. It is the area of the building measured to the plaster finish of the perimeter walls at each floor level. The measurement includes internal walls, service boxings and voids over stairs. It excludes internal garages and areas with less than 1.5m headroom. All dimensions are + or - 50mm and floor plans are not shown to scale. The kitchen layout and furniture positions are for indicative purposes only. The computer generated image is for illustrative purposes only and it is from an imaginary viewpoint within an open space area. Its purpose is to give a feel for the development, not an accurate description of each property. The illustration shows a typical Taylor Wimpey home of this type, but there are, however, variances from site to site. External materials, finishes, landscaping and the position of garages (where provided) may vary throughout the development. Properties may also be built handed (mirror image). Images may include optional upgrades at an additional cost. Please ask for further details.TWNW 81900 / January 2025.



The Lydford

4 BEDROOM HOME, TOTAL NET 1,083 SQ FT



GROUND FLOOR

Lounge

4.49m x 3.27m 14' 9" x 10' 9"

Kitchen/Dining

5.36m x 3.38m 17' 7" x 11' 1"



FIRST FLOOR

Bedroom 1

3.79m x 3.17m 12' 5" x 10' 5"

Bedroom 2

3.35m x 3.17m 11' 0" x 10' 5"

Bedroom 3 max.

3.30m x 2.10m 10' 10" x 6' 11"

Bedroom 4 min.

2.23m x 2.10m 7' 4" x 6' 11"



[Discover more about this home](#)



[View development](#)

*Plot specific windows. The floor plans depict a typical layout of this house type. For exact plot specification, details of external and internal finishes, dimensions and floor plan differences consult your sales executive. The sq ft/ sq m stated is the net sales area described in the RICS Code of Measurement 6th Edition. It is the area of the building measured to the plaster finish of the perimeter walls at each floor level. The measurement includes internal walls, service boxings and voids over stairs. It excludes internal garages and areas with less than 1.5m headroom. All dimensions are + or - 50mm and floor plans are not shown to scale. The kitchen layout and furniture positions are for indicative purposes only. The computer generated image is for illustrative purposes only and it is from an imaginary viewpoint within an open space area. Its purpose is to give a feel for the development, not an accurate description of each property. The illustration shows a typical Taylor Wimpey home of this type, but there are, however, variances from site to site. External materials, finishes, landscaping and the position of garages (where provided) may vary throughout the development. Properties may also be built handed (mirror image). Images may include optional upgrades at an additional cost. Please ask for further details.TWNW 81900 / January 2025.



The Trusdale

4 BEDROOM HOME, TOTAL NET 1,226 SQ FT



GROUND FLOOR

Lounge

3.46m × 6.09m 11' 4" × 20' 0"

Kitchen/Dining

3.58m × 6.09m 11' 9" × 20' 0"



FIRST FLOOR

Bedroom 1

3.52m × 3.03m 11' 7" × 9' 11"

Bedroom 2

3.64m × 2.95m 11' 11" × 9' 8"

Bedroom 3

2.51m × 3.05m 8' 3" × 10' 0"

Bedroom 4

3.54m × 2.25m 11' 7" × 7' 5"

[→ Discover more about this home](#)

[→ View development](#)

*Plot specific windows. The floor plans depict a typical layout of this house type. For exact plot specification, details of external and internal finishes, dimensions and floor plan differences consult your sales executive. The sq ft/ sq m stated is the net sales area described in the RICS Code of Measurement 6th Edition. It is the area of the building measured to the plaster finish of the perimeter walls at each floor level. The measurement includes internal walls, service boxings and voids over stairs. It excludes internal garages and areas with less than 1.5m headroom. All dimensions are + or - 50mm and floor plans are not shown to scale. The kitchen layout and furniture positions are for indicative purposes only. The computer generated image is for illustrative purposes only and it is from an imaginary viewpoint within an open space area. Its purpose is to give a feel for the development, not an accurate description of each property. The illustration shows a typical Taylor Wimpey home of this type, but there are, however, variances from site to site. External materials, finishes, landscaping and the position of garages (where provided) may vary throughout the development. Properties may also be built handed (mirror image). Images may include optional upgrades at an additional cost. Please ask for further details.TWNW 81900 / January 2025.



The Felton

5 BEDROOM HOME, TOTAL NET 1,581 SQ FT



GROUND FLOOR

Lounge

3.14m x 4.62m 10' 4" x 15' 2"

Kitchen/Dining min.

7.89m x 2.50m 25' 11" x 8' 2"

Study

2.52m x 2.19m 8' 3" x 7' 2"



FIRST FLOOR

Bedroom 1

3.14m x 5.02m 10' 4" x 16' 6"

Bedroom 4

2.51m x 3.24m 8' 3" x 10' 8"

Bedroom 5

2.30m x 3.19m 7' 7" x 10' 6"



SECOND FLOOR

Bedroom 2

3.15m x 3.25m 10' 4" x 10' 8"

Bedroom 3

3.40m x 2.16m 11' 2" x 7' 11"



[View development](#)

*Plot specific windows. The floor plans depict a typical layout of this house type. For exact plot specification, details of external and internal finishes, dimensions and floor plan differences consult your sales executive. The sq ft/ sq m stated is the net sales area described in the RICS Code of Measurement 6th Edition. It is the area of the building measured to the plaster finish of the perimeter walls at each floor level. The measurement includes internal walls, service boxings and voids over stairs. It excludes internal garages and areas with less than 1.5m headroom. All dimensions are + or - 50mm and floor plans are not shown to scale. The kitchen layout and furniture positions are for indicative purposes only. The computer generated image is for illustrative purposes only and it is from an imaginary viewpoint within an open space area. Its purpose is to give a feel for the development, not an accurate description of each property. The illustration shows a typical Taylor Wimpey home of this type, but there are, however, variances from site to site. External materials, finishes, landscaping and the position of garages (where provided) may vary throughout the development. Properties may also be built handed (mirror image). Images may include optional upgrades at an additional cost. Please ask for further details.TWNW 81900 / January 2025.

Ways to buy

Everyone knows buying a new home is an exciting time. But it can be a stressful one too, which is why our sales executives and customer relations managers are there to help every step of the way, from your initial enquiry right through to opening the front door of your new home for the first time.



First time buyer?

 Here's how we can help

Existing home owner?

 Here's how we can help



Take your next step



Find your dream home
on our website.



**Book an
appointment to
view our show homes.**



Take a virtual tour of
our homes from the
comfort of your sofa.



Have your questions
answered by calling
our sales executives on
01270 449 417.



Find out how we can
get you moving with
our buying schemes.



Book an appointment



How to buy a home



KINGSBOURNE Waterlode, Reaseheath, Nantwich, Cheshire CW5 5BS

CONTACT US ON 01270 449 417

Taylor Wimpey

Taylor Wimpey in their efforts to improve designs reserve the right to alter site plans, floor plans, elevations and specifications without notice. All lifestyle and location imagery used within this brochure is indicative only. Taylor Wimpey houses are sold freehold and apartments are sold leasehold. Please see the development page on our website for further details. For terms and conditions on our schemes and incentives including Help to Buy, Part Exchange and easymover, go to www.taylorwimpey.co.uk/terms. Information is correct at the time of going to print. Please speak to your sales executive for further details.